

Soft-Close damper

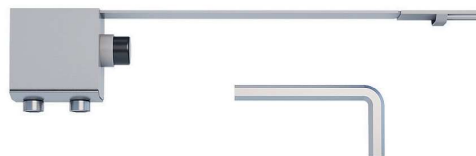

Activator

**Step 1:**

If any screws have been used when mounting the sliding door frame and if these have been placed inside the running track, where the activator have to be positioned – these screws have to be removed or re-positioned before mounting the activator.

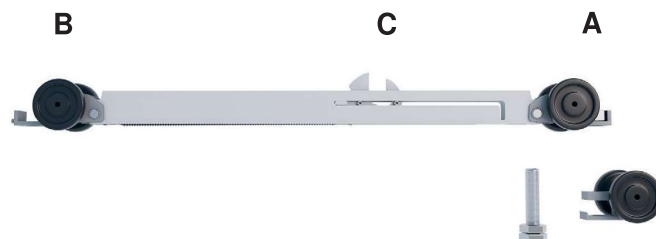
**Step 2:**

Dismantle the damper by unscrewing bolt A and removing the extra wheelset!

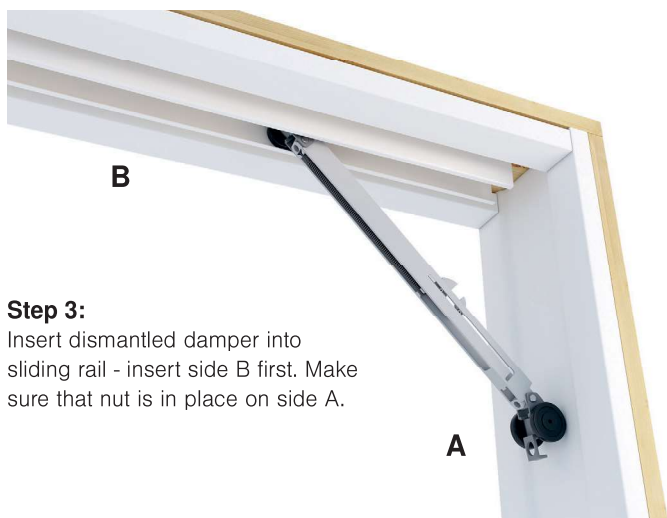
**Step 3:**

Insert dismantled damper into sliding rail - insert side B first. Make sure that nut is in place on side A.

**Step 4:**

Insert support wheel A (make sure that nut is in place) - click in place on main wheel A. Lock in place with bolt A.

**Step 5:**

The Soft-Close system should now look as picture above. Locking pin: Insert and lock in place as shown above. Mount sliding door as normal.

**Step 6:**

Insert and fasten activator as shown - adjust by changing activator position.



Produsert av:
Scanflex AS
Postboks 155
N-4795 Birkeland
Norway

Telefon +47 37 28 00 00
Faks +47 37 28 00 10
post@scanflex.no
www.scanflex.no